

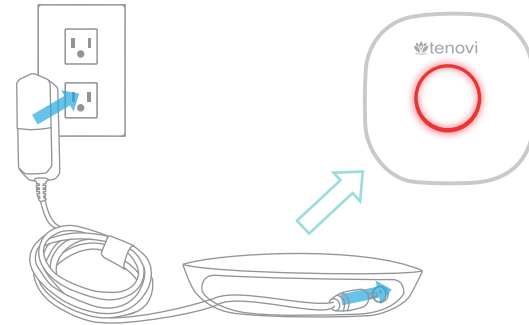

© 2023 Tenovi Co.
All rights reserved. Republication, duplication or modification
in whole or in part is prohibited without prior written permission
from Tenovi. All trademarks are owned by or licensed to
Tenovi, Co. unless otherwise noted.
Revision 05.01.2021

- 1** Plug your gateway into a power outlet with the provided power cord and wait until the LED on the gateway turns red.



- 2** Insert the two batteries into the back of your blood pressure monitor.

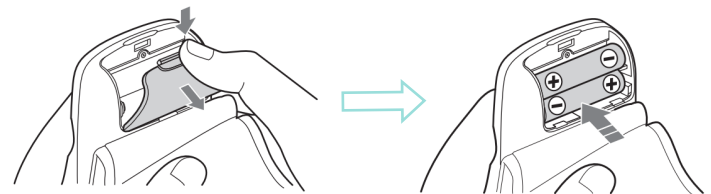

- 3** Tie the cuff on your upper arm and position the artery. Leave 1/2 an inch between the cuff and your palm.

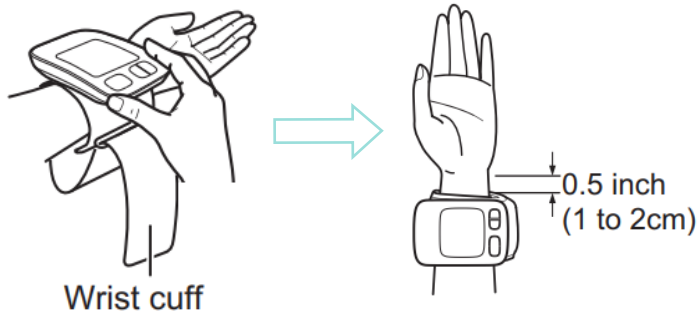

- 4** Sit comfortably with your tested arm resting on a flat surface at the same level as your heart. Relax your arm and hand onto the table and turn your palm upwards.

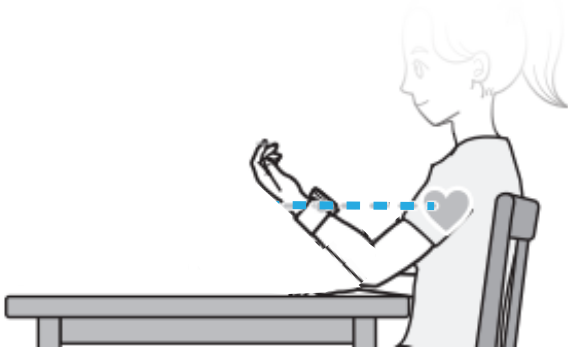

- 5** Press the “Start/Stop” button to take a measurement. If the LED ring is **Green**, you have properly taken a measurement for the day and that measurement has been successfully transmitted.

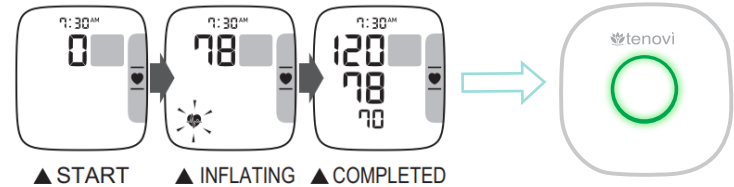

- 6** **Take one measurement once per day unless otherwise advised by your healthcare provider.** The LED on your Tenovi device will turn **Red** at the beginning of each day indicating you must take measurement for that day. The LED ring will turn **Green** when you successfully take a measurement and transmit it to your healthcare provider.



Measurement Needed



Measurement Successful